

Assembly instructions

PO502 PO521 PO522 Tension Fabric Display Straight

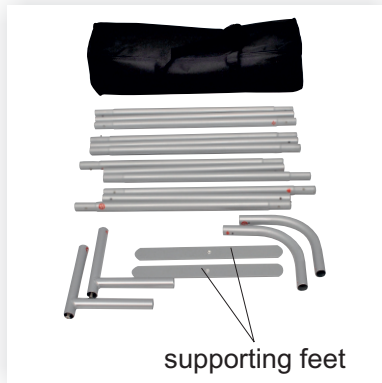

The contents of the package:

- Textile carry bag: 1 piece
- Textile graphic: 1 piece
- Frame consisting of several aluminum tubes: 1 piece

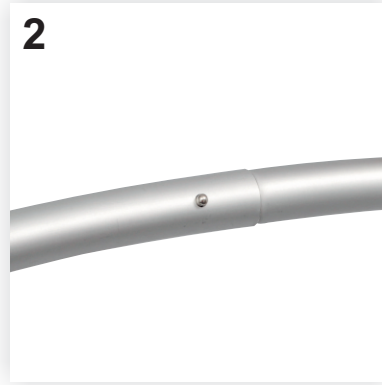

1-2. First join the aluminum tubes to form the support bars of the PopUp: insert each tube in his pair to which he is connected by an elastic, press the button on one of the tubes and push towards the other tube provided with an orifice as shown in Figure 1. When they combine correctly, you will hear a "click" and the button will come out through the hole as in Figure 2.

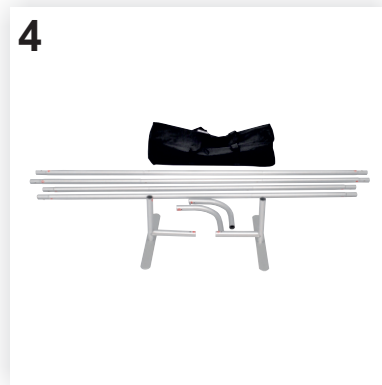

3-4. Fix the supporting feet on the corner elements with a screwdriver. You will get: four straight support bars (two long bars for the horizontal sides and two short bars for the vertical sides) and four corner elements (two corners with supporting feet for the lower corners and two curved corners for the upper corners).

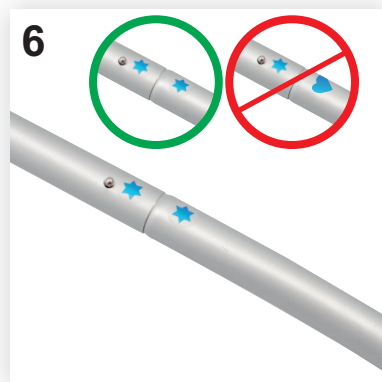

5-6. Applying the same method mentioned at pct. 1-2, add the corner items to the horizontal bars making sure to match the numbering / marking from the elements that merge, as in figures 5-6.

The pictures are for presentation only; your product can be slightly different!

Assembly instructions

PO502 PO521 PO522 Tension Fabric Display Straight



7

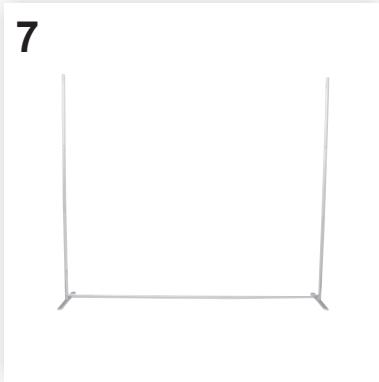

8

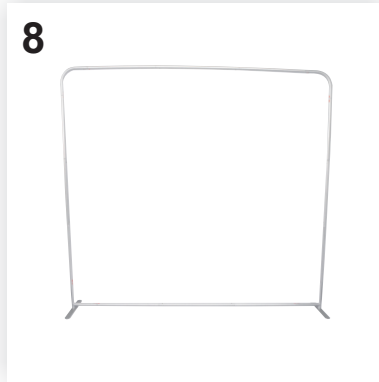

7. Join the two short straight bars with the horizontal bar with the supporting feet making sure to match the numbering / marking on the elements that join.

8. Add the second horizontal bar with previously mounted corner elements at the top of the system thus formed so that you'll get a complete frame. Now the PopUp structure is ready.

9



10

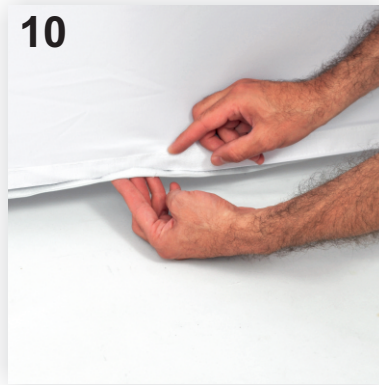

9. To add the textile graphic, you need to undo its zipper or velcro band, as the case may be. Then insert the graphic on the PopUp structure through the top, as in the adjacent picture.

10. Make sure you stretch well the customization and then close the zipper or velcro band, as the case may be. Mounted correctly, the customization will be slightly tense and wrinkles-free.

Tension Fabric
Display Straight

Now the system Tension Fabric Display Straight is assembled.

The pictures are for presentation only; your product can be slightly different!